

TV1-001H

TELEVISION MOUNT

INSTALLATION INSTRUCTIONS



Thank you for choosing a MORryde television mount! The snap-in swivel mount is designed to mount flat panel televisions or monitors weighing up to 50 lbs to a vertical surface or wall and swivels up to 15°.

Key Features and Benefits

- Low-profile design
- Easily mounted to any vertical surface
- No assembly required

Range of Motion*

- Swivels up to 15° in both directions

* For most applications

Product and Safety Information

The TV1-001H mounts flat panel televisions or monitors to a vertical surface in an outside entertainment center.

NOTE: This mount is not intended for use on brick, concrete, concrete block.

VESA* Mounting Plates

- 75mm x 75mm
- 100mm x 200mm
- 100mm x 100mm
- 200mm x 200mm

* Video Electronics Standards Association

Weight Capacity

- 50 lbs

Parts List

1. Mounting Plate
2. Wall Bracket
3. Hardware Pack

⚠ WARNING Improper installation may cause property damage or personal injury. The mounting surface may require reinforcement as it must be capable of supporting five times the combined weight of the television and the mount.

The installer assumes all responsibility of verifying that any installation method and mounting surface securely support the television and mount. MORryde is not liable for property damage or injury caused by incorrect mounting, installation methods not recommended by MORryde, hardware not provided by MORryde, or incorrect use of the mount during travel or otherwise.

Preparation

Television Stand

If applicable, remove the original base stand in accordance with the television owner's manual.

Hardware

Use appropriate hardware for securing your television to the mount and mounting your television to the mounting surface.



M4x12mm Bolt (4)



M5x12mm Bolt (4)



M6x12mm Bolt (4)



1/4" x 1" Lag Bolt (8)



M6 Flat Washer (8)



#10 Flat Washer (8)



1/4" Flat Washer (8)

Installation

⚠ WARNING Using mounting hardware too long for your application may puncture exterior structures.

⚠ WARNING If your television came with a stand, please remove the stand by referring to your television's owners manual and ensure the hardware has been removed from the mounting holes.

STEP 1

Secure the wall bracket to mounting surface: Pre-drill holes using a 1/8" drill bit for use with 1/4" lag bolts. Use lag bolts or self-drilling screws (depending on your mounting surface) with 1/4" washers to secure base of bracket to the mounting surface.



STEP 2

Secure the TV to the mounting plate: Line up the hole pattern on your television with the matching hole pattern on the universal mounting plate as close to the center as possible. Use the appropriate mounting hardware to secure the television to the mounting plate.

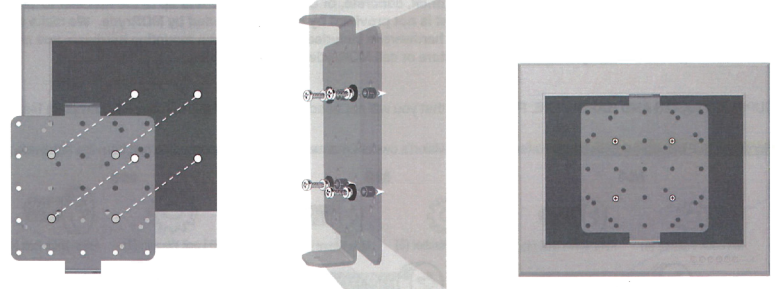

STEP 3

Assemble the mounting plate with television to the wall bracket: Assemble as shown to the right and use securing hardware to lock in place.

⚠ WARNING Step 3 may require two people to lift the television safely into place. MORyde is not responsible for property damage and/or personal injury due to improper or unsafe installation practices.

