



Above. Beyond. Always.

MORryde International, Inc. 1966 Sterling Avenue, PO Box 579, Elkhart, Indiana 46515

(574) 293-1581

Fax: (574) 294-4936

[www.MORryde.com](http://www.MORryde.com)

## Rubber Shear Spring Replacement Guide

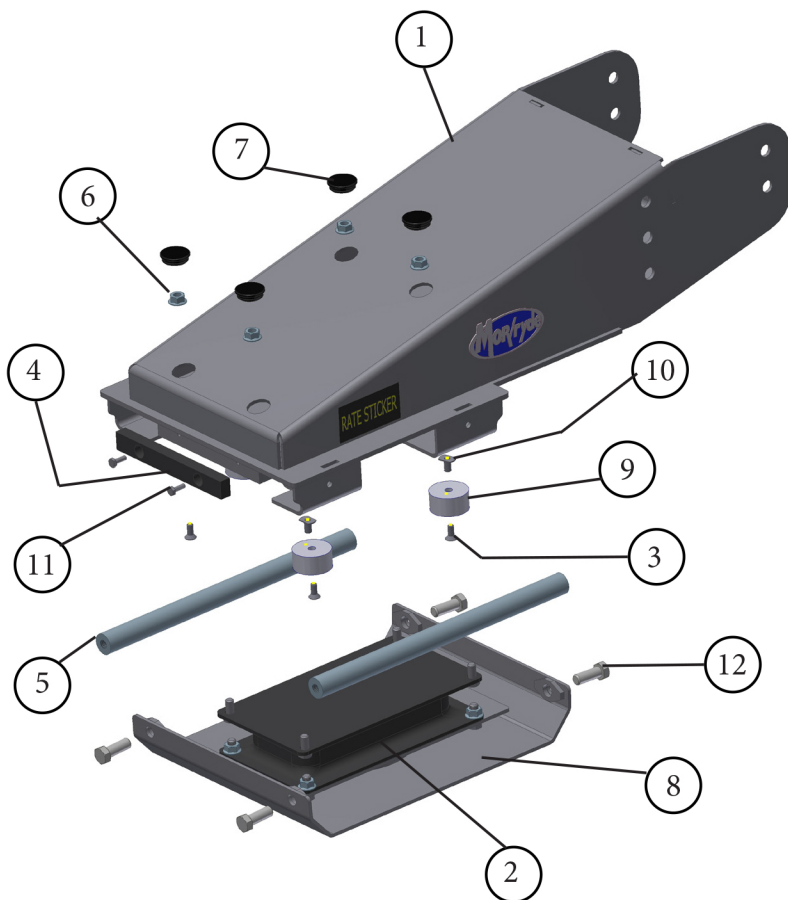

| Parts List |     |                           |
|------------|-----|---------------------------|
| ITEM       | QTY | DESCRIPTION               |
| 1          | 1   | UPPER MOUNTING ASSEMBLY   |
| 2          | 1   | SHEAR SPRING              |
| 3          | 4   | 5/16-18 BUTTONHEAD BOLT   |
| 4          | 2   | RUBER COMPRESSION BUMPER  |
| 5          | 2   | RETAINMENT ROD            |
| 6          | 8   | 7/16-14 FLANGE NUT        |
| 7          | 4   | ACCESS PLUG               |
| 8          | 1   | LOWER SKID PAD ASSEMBLY   |
| 9          | 4   | GLIDE PAD/DISC            |
| 10         | 2   | 5/16-18 T-NUT             |
| 11         | 4   | 1/4-20 SELF TAPPING SCREW |
| 12         | 4   | 9/16-12 BOLT              |

- 1.) Support the king pin (example: tripod jack, hitch in truck).
- 2.) Remove the 4 retainment rod bolts by securing retainment rod with vice grips (#12).
- 3.) Remove the 4 rubber plugs in the top of your box (#7).
- 4.) Remove the 4 nuts holding on the rubber spring (#6).
- 5.) Your skid pad assembly (#8) is now separated from your pin box. Slowly bring down your tripod jack.
- 6.) Remove the 4 nuts that are holding the rubber spring to the skid pad (#6).
- 7.) Using the same nuts, re-install the new spring onto the skid pad using lock tight on the studs.
- 8.) Re-install the lower skid pad assembly using the same nuts with loc-tite and torque to 40 ft. lbs.
- 9.) Reinstall the rubber plugs.
- 10.) Line up the retainment rods with skid pad and re-install the bolts. Torque retainment bolts to 90 ft. lbs.