

RUBBER PIN BOX

OPERATING INSTRUCTIONS AND OWNER'S MANUAL



Above. Beyond. Always.

Congratulations on the purchase of your MORryde Pin Box System. This revolutionary new system redefines the experience of towing a 5th wheel. No longer will you have to live with the harsh, jerky, back-and-forth motion associated with towing. You can also forget about excessive wear and tear on your truck and RV and the added strain that this puts on drivers and passengers.

Your new Pin Box System provides:

- Greatly reduced back-and-forth chucking and jerking
- Cushioned sensation over uneven road conditions
- Jerk-free starts and stops
- Smoother, more comfortable in-cab ride

Each MORryde Pin Box System has been carefully engineered to match the existing pin box that it replaces. Our pin box is fully adjustable* and maintains the king pin location established by the original trailer manufacturer. By maintaining the static king pin location, stress and strain subjected to the trailer frame structure is consistent with the original king pin location.

This manual will outline basic troubleshooting and preventative maintenance procedures associated with this system. Service manuals and instructions are provided with replacement parts.

* The MORryde Pin Box is fully adjustable for most applications.



Above. Beyond. Always.

PARTS LIST

1. Upper mounting assembly
2. Shear spring
3. 5/16-18 buttonhead bolt
4. Rubber compression bumper
5. Retainment rod
6. 7/16-14 flange nut
7. Access plug
8. Lower skid pad assembly
9. Glide disc
10. 5/16-18 T-nut
11. 1/4-20 self-threading screw
12. 9/16-12 bolt

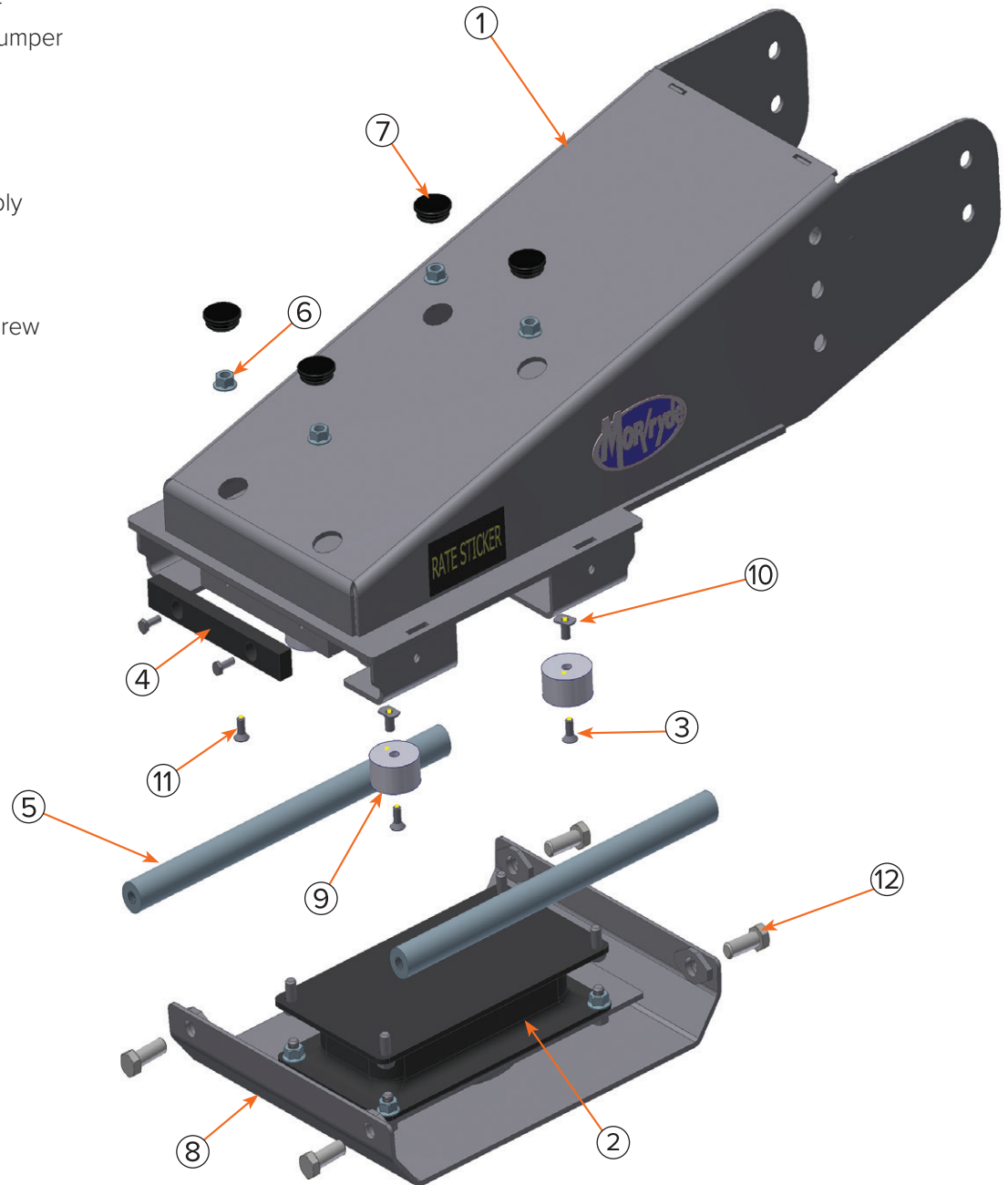

COMPATIBILITY

Your MORryde Pin Box System is compatible with:

- PullRite® SuperGlide
- Lube Disc

Gooseneck Adaptors

Many customers ask about using the MORryde Pin Box with a gooseneck adaptor; it is important to know that doing so may void the frame warranty of your 5th wheel. For this reason, we recommend that you contact the trailer manufacturer to determine whether a gooseneck adaptor can be used. You should also be aware that gooseneck adaptors increase the applied torque to the frame structure of the trailer which may lead to structural failures. If you still wish to utilize a gooseneck adaptor with the MORryde Pin Box, you **MUST** purchase and install a MORryde heavy duty skid plate (Part # RPB77-006). Even with the installation of the heavy duty skid plate, you assume all liability and risk of property damage and personal injury associated with the use of the gooseneck adaptor.

⚠ WARNING Gooseneck adaptors with an offset must **NEVER** be used with a MORryde Pin Box.

PREVENTATIVE MAINTENANCE

- Annually inspect king pin for excessive wear.
- Inspect the skid pad to ensure a neutral (centered) position. When the trailer is disconnected from the tow vehicle, an equal gap of approximately 1- 1/4" should be observed between the lip of the skid pad and the rubber compression bumpers. It is normal to slightly move and twist the skid pad assembly with hand force.
- Inspect the retainment rods for excessive wear. The retainment rods may show surface scratch marks as an indication of occasional contact but the scratches, if present, should be minimal.
- Inspect the plastic glide discs for excessive wear. The glide disc thickness should be no less than 3/4".
- Repaint pin box to prevent rust and maintain its appearance. **NOTE:** Do **NOT** paint over labels.
- Periodically check the torque values of all hardware. Torque specifications are listed below.

TORQUE SPECIFICATIONS

LOCATION	BOLTS		TORQUE
	(GR5)	(GR8)	VALUE
Attaches upper mounting assembly to skid pad		7/16-14	55 ft-lbs.
Retainment rods	9/16-12		90 ft-lbs.
Attaches upper mounting assembly to wing assembly. Uses 1/2", 5/8", or 3/4" attaching bolt depending on Pin Box System	1/2-13 5/8-11 3/4-10		65 ft-lbs. 135 ft-lbs. 220 ft-lbs.

Note: The 5/16-18 buttonhead bolt that attaches the glide disc to the upper mounting assembly should be hand-tightened so that the bolt head begins to sink into the plastic. Prior to installation, a drop of blue Loctite should also be applied to the threads on the end of this bolt.



Above. Beyond. Always.

TROUBLESHOOTING

PROBLEM	REMEDY
Trailer not level.	Adjust pin box or hitch accordingly.
Excessive bottoming of skid pad assembly. Jerky ride in tow vehicle.	Inspect to ensure that the rubber compression bumpers are in place. Check trailer brakes for proper operation. If above is satisfactory, it may be necessary to install a shear spring with a different spring rate. Contact MORryde's Parts Department for assistance; they will require your actual trailer weight to assist.
Skid pad assembly does not return to neutral position when disconnected from tow vehicle.	Check for loose or torn rubber shear spring.
Excessive noise from pin box area.	Verify that the pin box is securely attached to the 5th wheel. If the king pin is excessively worn, the skid pad will need to be replaced. Hitch mechanisms can also cause noise. Verify that unwanted noise is not coming from the hitch. Your hitch manufacturer can provide guidelines for this check.

WARRANTY

Please visit www.MORryde.com for warranty information.

At MORryde, we have a passion for solving problems. Whether we're fabricating custom solutions, modifying a commercial chassis, or creating our innovative products, we answer to a wide range of markets and deliver on a variety of needs. At MORryde, it's simply about doing MORE for our customers, and it doesn't stop at the sale. We stand behind our products, believing in quality first, service always. No matter the issue, we'll be the first to respond and the last to be satisfied. In short, we build better — together.



Above. Beyond. Always.

574.293.1581 • MORryde.com •    