

THE CHAIR BUDDY™

INSTALLATION INSTRUCTIONS

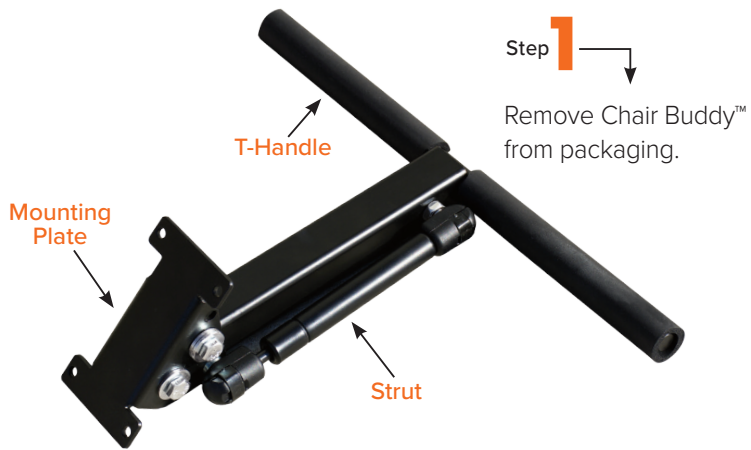

Step 1 →
Remove Chair Buddy™ from packaging.



Step 2 →
Position the mounting plate as high as possible against the center post. The T-handle should be touching the underside of the table. On the post, mark the bottom of the mounting plate with a pencil.

Note: If the table does not have a center post, an adapter plate can be purchased separately to accommodate Chair Buddy™.

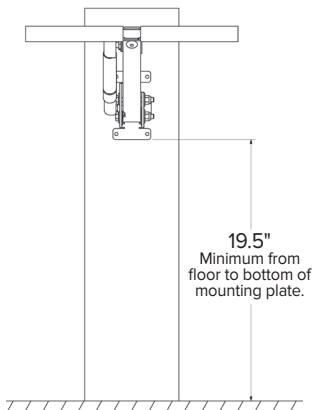

Step 3 →
Measure from the pencil mark to the floor to ensure it is a minimum of 19.5".



Step 4 →
With a pencil, mark the four screw locations using the mounting plate as your guide.



Step 5 →
With a 7/64th drill bit, drill a pilot hole approximately 1" deep for all four screw locations. (Must drill pilot holes or table post may split).



Step 6 →
Using only the bottom two holes, secure Chair Buddy to the post with the screws provided.



Step 7 →
Carefully pull Chair Buddy's T-handle down, then secure the top mounting holes with the screws provided.



Above. Beyond. Always.

574.293.1581
MORryde.com

