

MOUNTING THE UNIVERSAL FUEL CARRIER TRAY

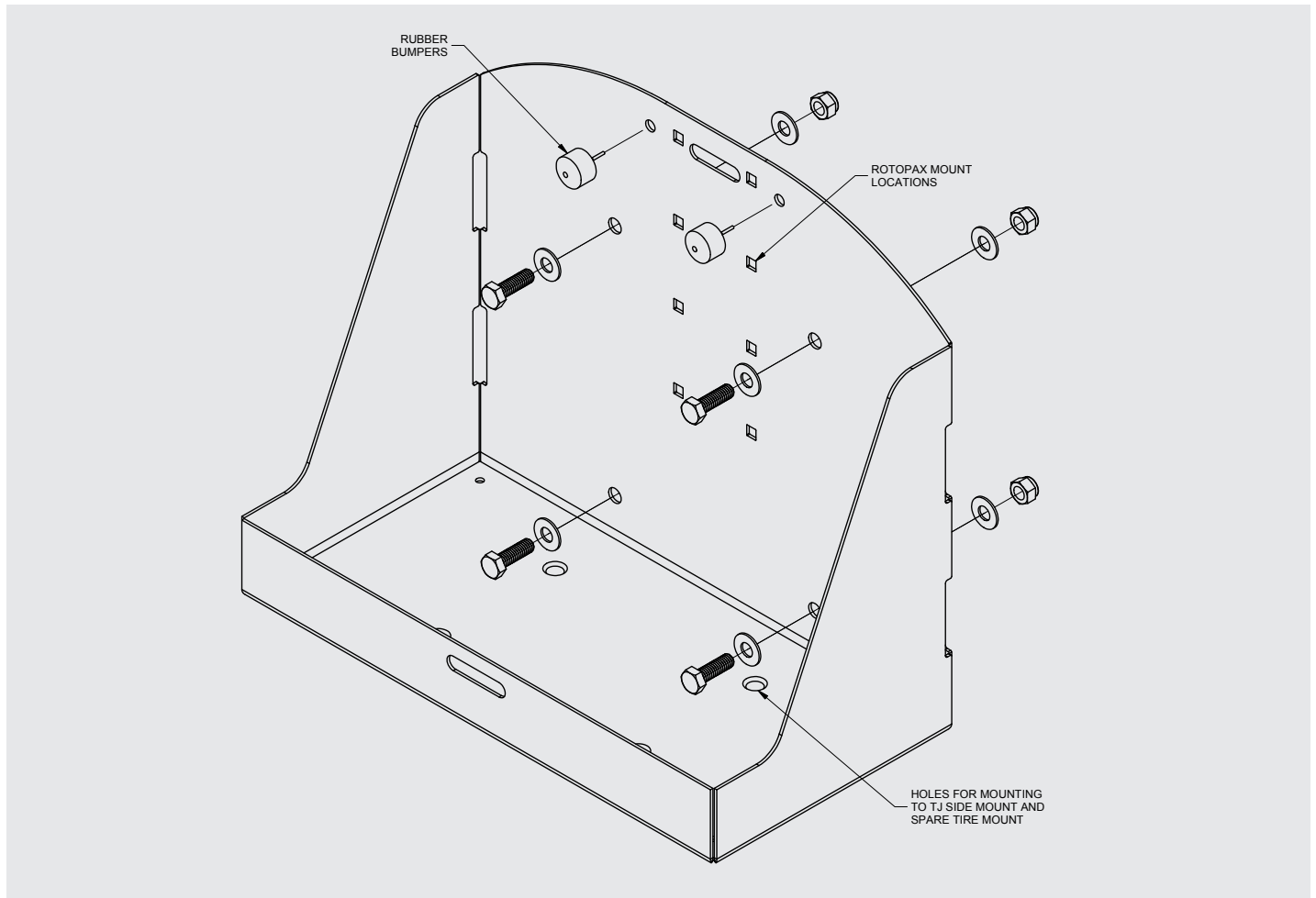

IF BEING USED WITH SIDE MOUNT FOR JK WRANGLER

Use provided hardware to attach tray to the mount in the configuration shown above.

Rubber bumpers and foam rubber pad should be used to protect fuel can and minimize rattling. Use the included ratchet strap to secure the fuel can to the tray.

IF BEING USED WITH A TJ SIDE MOUNT OR A SPARE TIRE MOUNT

Use existing hardware to connect the tray.

If Rotopax mount is to be used, attach Rotopax mount to one of three positions depending on can size. The rubber bumpers, foam rubber pad, and ratchet strap are not needed when using a Rotopax (JK and TJ).

If using with standard fuel cans, rubber bumpers and foam pad are recommended.